



ART OF glazing

Schrock begins with the application of a toner to enhance the natural characteristics of the finest woods. The glaze is then hand-wiped over the toner, bringing a new depth and dimension to every cabinet.

Varying amounts of glaze may collect in the corners and grooves of the door profiles, adding to its charm and authenticity. (See examples on right side.)

HAND-WIPING AMOUNT MAY VARY PER CABINET.

Depending on the detail of the door, coverage may range from even and consistent to varied and dramatic.



Color saturation may vary on cabinets and doors throughout the room.

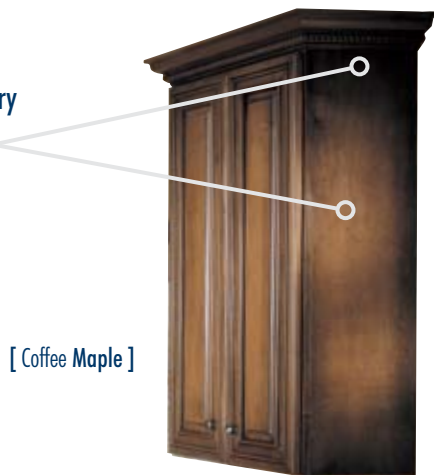

[Coffee Maple]

GLAZE APPLICATION WILL VARY FROM DOOR TO DOOR.

[Amaretto Crème Maple]



[Toasted Almond Maple]



[Butternut Maple]



[Whiskey Black Maple]

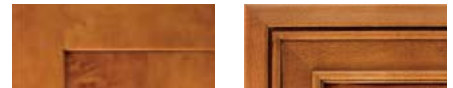

[Whiskey Black Rustic Alder]



[Whiskey Black Cherry]



[Coffee Maple]



[Coffee Rustic Alder]



[Coffee Hickory]



[Coffee Cherry]



[Palomino Maple]



[Palomino Rustic Alder]



[Palomino Cherry]



[Moss Maple]



[Crimson Maple]

